



**MISHIMOTO**

# INSTALLATION GUIDE

## BAFFLED OIL CATCH CAN KIT

FITS 2019+ CHEVY/GMC 1500 5.3L/6.2L

SKU: MMBCC-T1-19

### TABLE OF CONTENTS

- Pg 1** RESOURCES AND CONTACT INFORMATION
- Pg 2** EXPLODED VIEW
- Pg 3** IMPORTANT SAFETY INFORMATION  
DISCLAIMERS  
INSTALLATION INSTRUCTIONS
- Pg 6** DISPOSAL INSTRUCTIONS  
WARRANTY INFORMATION

### RESOURCES & CONTACT

-  **CALL 1-877-GOMISHI**  
CUSTOMER SERVICE HOURS: MON-FRI 8:30AM-5:00PM EST
-  **MISHIMOTO**
-  **GOMISHIMOTO**
-  **MISHIMOTO**
-  **WEBSITE**  
[WWW.MISHIMOTO.COM](http://WWW.MISHIMOTO.COM)
-  **ENGINEERING BLOG**  
[WWW.MISHIMOTO.COM/ENGINEERING](http://WWW.MISHIMOTO.COM/ENGINEERING)

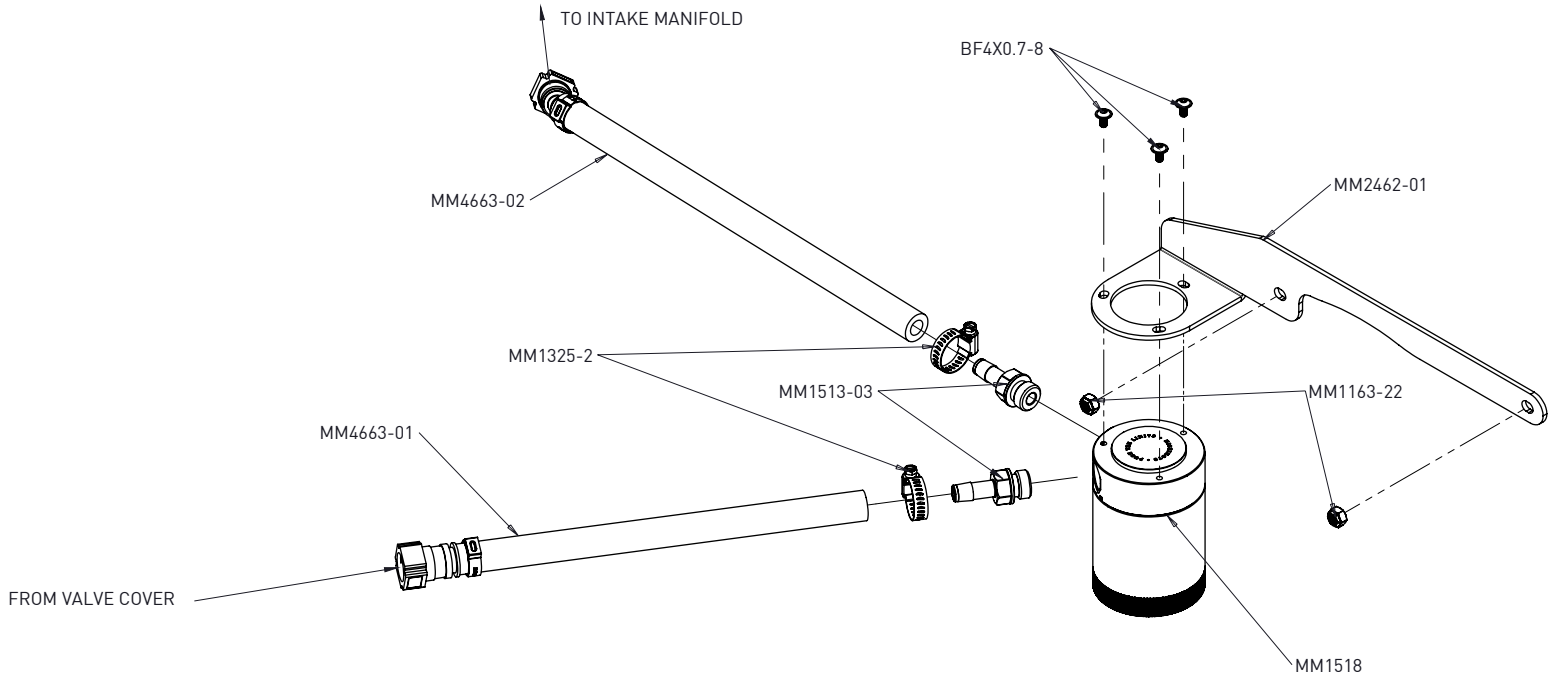

## PARTS BREAKDOWN

PART NUMBER	DESCRIPTION	QTY
MM2462-01	BRACKET	1
MM4663-01	HOSE ASSEMBLY 1	1
MM4663-02	HOSE ASSEMBLY 2	1
MM1518	COMPACT CATCH CAN	1
MM1513-03	CATCH CAN FITTING	2
BF4X0.7-8	M4 BOLT	3
MM1163-22	M6 LOCK NUT	2
MM1325-2	WORM GEAR CLAMP	2

## IMPORTANT SAFETY INFORMATION

- › Mishimoto recommends you use safety glasses and protective gloves during the installation of our products
- › Raise vehicle only on jack stands or on a vehicle lift
- › Allow vehicle to cool completely prior to attempting installation
- › Do not run the engine or drive the vehicle while overheating; serious damage can occur
- › Please dispose of any liquids properly
- › Mishimoto is not responsible for any vehicle damage or personal injury due to installation errors, misuse, or removal of Mishimoto products
- › If you need any assistance while installing our products, reach out to our Customer Service Team at 1-877-GOMISHI

## REQUIRED TOOLS

- |   |                        |
|---|------------------------|
| 2.5MM ALLEN KEY                             | ¼" DRIVE EXTENSIONS    |
| ¼" DRIVE 10MM DEEP SOCKET                   | ¼" DRIVE RATCHET       |
| ¼" DRIVE 7MM SOCKET OR FLATHEAD SCREWDRIVER | 17MM OPEN ENDED WRENCH |

## INSTALL TIME 30-45MINS

## INSTALL DIFFICULTY

## DISCLAIMERS

- › This instruction manual is focused on installing a Mishimoto part and may not comprehensively cover removal and reinstallation of factory components
- › Raise vehicle only on jack stands or a vehicle lift. Never use only a jack.
- › Allow vehicle to cool completely before attempting installation
- › Do not run engine or drive vehicle while overheating, as serious damage may occur.
- › Please dispose of any liquids properly.

## INSTALLATION INSTRUCTIONS

1. Detach the passenger side PCV line from the intake by pressing down on the grey tab and pulling away from the intake.



2. With a 7mm socket or flathead, loosen the 2x clamps on the intake assembly. The first clamp is located behind the mass air flow sensor and the second clamp is located at the throttle body. Remove the intake from the throttle body and mass air flow sensor and rotate the intake assembly counter-clockwise out of the way.



Continued on next page

**3.** Remove the PCV line from the passenger side valve cover by pressing in the grey tab and pulling away from the engine. Remove the PCV line from the intake manifold in a similar fashion and remove the line from the vehicle. It may be helpful to remove the ignition coil electrical connector next to the intake manifold fitting for easier removal. If you have a 6.2L engine, the intake manifold fitting will be located just above the throttle body.

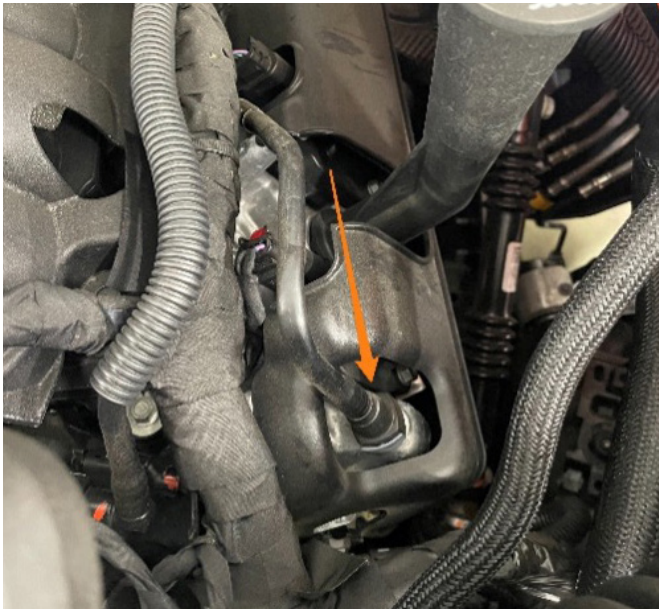

**4.** Remove the 1x 10mm bolt securing the coolant reservoir to the vehicle. Remove the reservoir off the studs on the firewall but do not attempt to remove it from the vehicle.

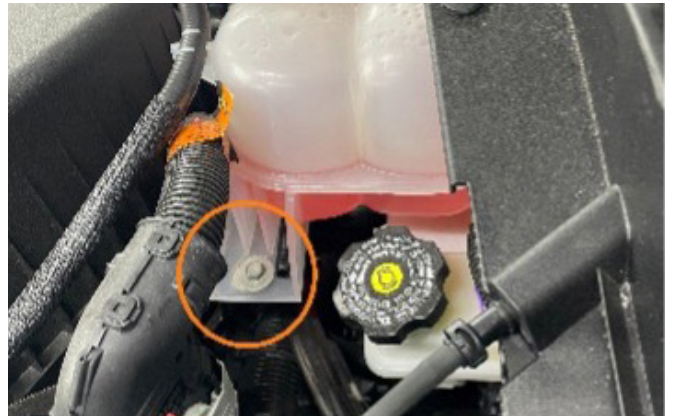

**5.** Install the 2x included fittings onto the catch can with a 17mm wrench. Then, secure the catch can to the bracket with the included M4 bolts, as shown. Do not fully tighten the bolts so that the assembly can be adjusted later.



Continued on next page

**6.** Install the catch can and bracket assembly onto the two studs on the firewall behind the coolant reservoir. Secure with the two included 10mm lock nuts. Reinstall the coolant reservoir with the factory 10mm bolt.



**7.** If you have a 5.3L engine, take the hose with the 45 degree fitting and cut the hose length down to approximately 295mm (this hose is a little longer so that it will also fit the 6.2L engine). Attach the quick connect fitting to the fitting on the intake manifold. Attach the open side of the hose to the "OUT" fitting on the catch can. Install the included worm gear clamp on the end of the hose and tighten. The worm gear clamp is optional and the catch can will function leak free without the clamp. Make sure the hose is not kinked when fully installed. The intake manifold fitting is located just above the throttle body on the 6.2L engine.



**8.** Take the hose with the straight fitting and install the quick connect fitting to the fitting on the valve cover. Attach the open side of the hose to the "IN" fitting on the catch can and secure with included worm gear clamp. The worm gear clamp is optional and the catch can will function leak free without the clamp. *(Image on Top Right)*



**9.** Adjust the catch can in the slotted holes, ensuring that it clears the engine oil fill cap and none of the hoses are kinked. Tighten the 3x bolts with a 2.5mm allen key..

**10.** Reinstall the intake assembly. Make sure to tighten the clamps and reattach the passenger side PCV fitting. If the mass air flow sensor or ignition coil connectors were removed, reconnect them.

**11.** Check the contents of the catch can after 1000 miles of driving to establish how fast the catch can fills in your specific vehicle. Make sure to empty the catch can contents before the can is full.

**Congratulations! You have finished your installation!**

Continued on next page

## DISPOSAL INSTRUCTIONS

- › Do not dispose of any product as unsorted municipal waste. Use separate collection facilities. Contact your local authority for information regarding the collection systems available.
- › Never improperly dispose of any coolant, oil, or other chemicals.

## WARRANTY INFORMATION



- › All claims must be accompanied with a picture of the Mishimoto product showing the issue for which the claim is being submitted.
- › Mishimoto asks that the customer inspect their purchased item for any damage immediately upon arrival.
- › Any product deemed dead on arrival (DOA) must be claimed within 14 business days of delivery. Claims outside of this time frame will not be covered under the Mishimoto Lifetime Warranty.
- › This warranty does not include payment and/or reimbursement of the cost of labor in connection with the removal of any product returned pursuant to the warranty policy or in connection with the installation of any replacement items provided under the warranty policy.
- › Mishimoto has the right to refuse a claim at any time.

- › When Mishimoto accepts a claim, Mishimoto retains full discretion to choose if it will: (i) repair or replace purchaser's original Mishimoto product; (ii) replace purchaser's original Mishimoto product with the most current available model; or (iii) provide the purchaser with a gift card redeemable on [Mishimoto.com](http://Mishimoto.com) in the amount of the original purchase price of the original Mishimoto product. The provision of a replacement of a Mishimoto product is subject to availability and Mishimoto retains the right to substitute any warranty claim item with a comparable item or credit at any time.
- › If Mishimoto determines that it will provide a replacement item in connection with a claim under this warranty policy, and such item is out of stock, Mishimoto will place the customer on backorder and ship the replacement product to the purchaser once it becomes available.
- › Mishimoto is not liable for incorrect shipments in connection with a claim if a claim form is completed incorrectly, or if a model number is not included in a claim.
- › If you have a vehicle equipped with an automatic transmission, please make sure to specify this within the text box on the claim form. Mishimoto is not responsible for incorrect replacement shipments if transmission type is not indicated.



**WARNING**  
Cancer and  
Reproductive Harm  
[www.P65Warnings.ca.gov](http://www.P65Warnings.ca.gov)

This product can expose you to chemicals which are known to the state of California to cause cancer. For more information visit: [www.p65warnings.ca.gov](http://www.p65warnings.ca.gov)